



# Courtside Banquet Hall

*Elegance Defined*

## WELCOME...

We invite you to take a tour of our modern, elegant reception hall conveniently located minutes south of down-town Lincoln. As you arrive, pull your vehicle under the covered drop off entrance.

Impress your guests as they enter our beautiful foyer lined with pillars and mirrors. The vaulted ceilings, crystal chandeliers, and other décor create a welcoming atmosphere for receiving and greeting guests. It is here, in our formal entry area, that you and your guests may take a private moment, leave your wraps, freshen up, and prepare for the entrance to the event of a lifetime.

Open the frosted doors to our 10,000 square foot banquet hall. On your left, you'll see an expansive, raised stage equipped for presentations, music, or live entertainment. A sixteen hundred square foot dance floor awaits you, enticing your feet to dance.

Our service area is straight ahead and equipped with oversized counter tops, a sink, and a refrigerator to accommodate all your catering and beverage needs.

On your right, there is ample room for up to 400 of your special guests to dine and socialize at round tables. Feel the warm ambiance provided by the lighted ficus trees carefully placed around the room and match the mood with dim lighting.

Our team of professionals is dedicated to making sure that your event is one that will generate fond memories for years to come.



Our Banquet Facility and Event Coordinator give you the ability for you to set-up your own floor plan and seating for up to 450 guests. Other features include:

- 500 square foot raised stage,
- 10,000 square foot banquet hall
- 1500 square foot dance floor
- Ladies' lounge,
- Seven televisions with cable TV, DVD, & VHS capability,
- Disco Ball above dance floor
- Formal reception entry with coat closet
- Large counter tops with sink and refrigerator
- Dim lighting
- Variety of drink options
- Built-in sound system
- LCD projector/screen

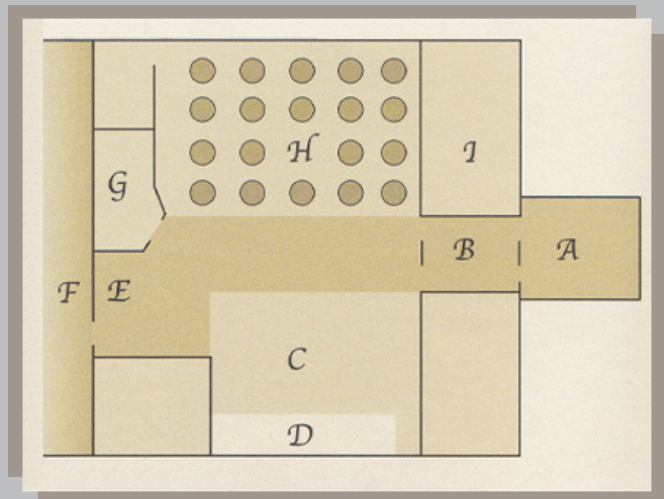

- A - Covered Entrance
- B - Foyer, Coat Room
- C - Dance Floor
- D - Stage
- E - Service Area
- F - Sports Complex
- G - Restrooms
- H - Dining Area
- I - Storage